

WET POND 3	
MANAGED TURF	0.50 AC
IMPERMEABLE	0.98 AC
TOTALS	1.48 AC
BMP TYPE	WET POND LVL. 1 (P-BAS-02)
PHOSPHORUS REMOVAL RATE	50%
PHOSPHORUS REMOVED	0.59 LBS
BMP TREATMENT VOLUME	3,743 CF
REQ. FOREBAY VOLUME	562 CF
WET POND TREATMENT VOLUME	3,181 CF
NORTHING	3453545.79
EASTING	10516886.16

FOREBAY STAGE STORAGE TABLE				
ELEV	AREA (sq. ft.)	DEPT H (ft)	AVG END INC. VOL. (cu. ft.)	AVG END TOTAL VOL. (cu. ft.)
2,061.000	532.62	N/A	N/A	0.00
2,062.000	1,222.53	1.000	877.57	877.57
2,063.500	2,551.92	1.500	2830.84	3708.41
2,064.000	3,256.21	0.500	1452.03	5160.44

WET POND STAGE STORAGE TABLE				
ELEV	AREA (sq. ft.)	DEPT H (ft)	AVG END INC. VOL. (cu. ft.)	AVG END TOTAL VOL. (cu. ft.)
2,062.000	14.00	N/A	N/A	0.00
2,064.000	264.32	2.000	278.32	278.32
2,065.000	489.34	1.000	376.83	655.15

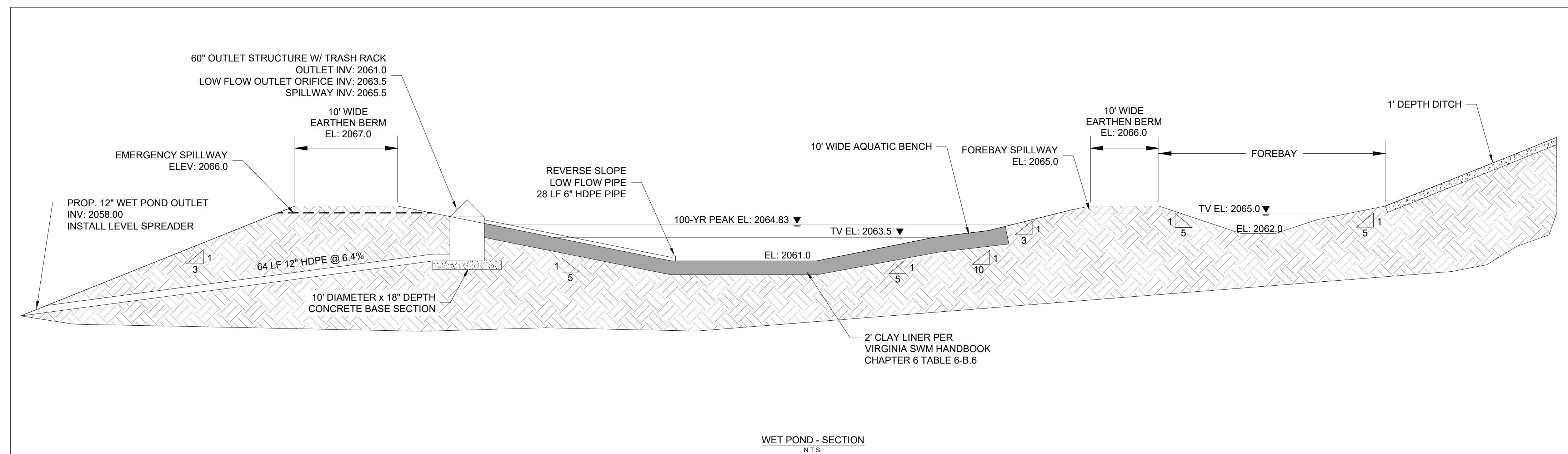
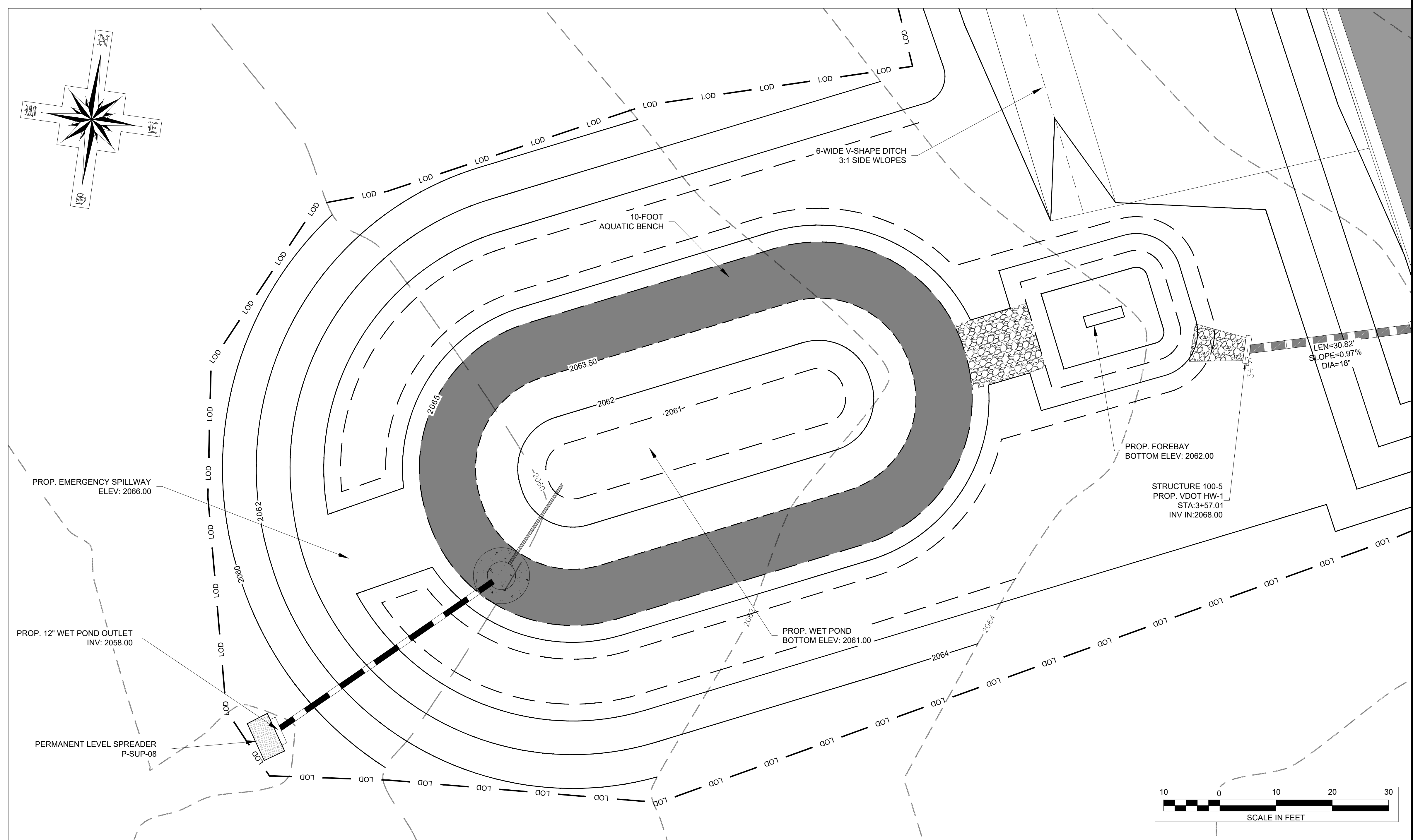

File: E:\WASHINGTON COUNTY, VIRGINIA\EMIS FACILITY\GLADE SPRING\GLADE SPRING\EMIS SITE DESIGN\DWG

Rinker Design Associates, LLC
 310 Valley Street, NW, Abingdon, Virginia 24210
 Telephone: 276.206.8571 | www.rdrctll.com

**NEW EMS FACILITY FOR
 WASHINGTON COUNTY, VIRGINIA
 HIGHLANDS BUSINESS PARK
 OWENS DRIVE
 GLANDE SPRING, VA 24340**

SITE/GRADING PLAN



DATE:	01-30-2026
NO.	REVISION DATE
1	
2	
3	
SHEET:	C203
DRAWN BY:	MPH
CHECKED BY:	MRL
PROJECT NO:	TLG-2515
THE LANE GROUP INC.	